

Cutting Unit Down Sensor(s)

The cutting unit down switch is a normally open (NO) reed switch located on the left front lift arm that closes when the lift arm is in the lowered position. As the lift arm is lowered, a bracket on the lift arm comes close to the switch, causing the reed switch to close and complete the circuit.

This sensor can be tested using the “Input Checks” feature of the ACE Diagnostic tool.

The sensor can also be tested manually.

1. Disconnect the switch wire connector and install continuity tester or ohm meter between the two switch leads.

2. With the lift arm in the lowered position the tester should show continuity. With the lift arm in the raised position, the tester should show no continuity.

Note: When the Enable/Disable switch is in ENABLE, the controller uses inputs from this switch to turn the cutting units on and off. When raising the cutting units with the Enable/Disable switch in ENABLE, the cutting units lift part way to a “turn around” position.

Note: The Reelmaster 6700-D also has sensors on each rear lift arm (one for cutting unit #6 and one for #7).

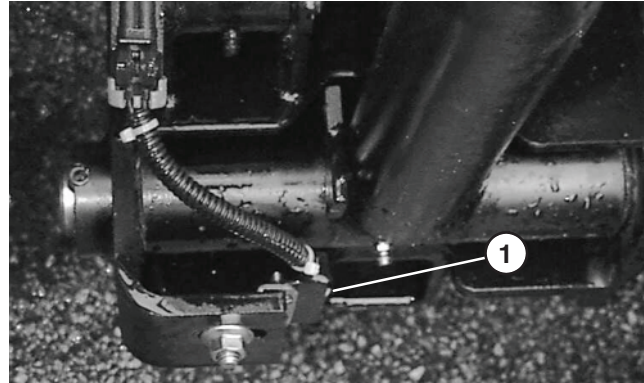

Figure 49
1. Cutting unit down switch
(front switch for units serial no 220000001 & up shown)

Adjustment

1. Move the lift arm toward the switch as far as it will move.
2. Move switch to lowest position on front lift arm. Note: for switch on RM 6700-D rear lift arm, move switch to highest position.
3. Adjust gap between switch and lift arm flag to .0625" (1.6 mm).

Cutting Unit #6 and #7 Reel On/Off Solenoids

These solenoids can be tested using the “Output Checks” feature of the ACE Diagnostic tool.

The solenoids can also be tested manually.

1. Disconnect the wire connector.

2. Connect a 12 volt battery so the positive (+) battery terminal is connected to colored solenoid lead. Connect the negative (-) battery terminal to black lead. The valve spool should retract completely as 12 VDC is applied between leads.

3. If valve spool does not operate properly check for binding or damage to valve.

4. If valve moves smoothly, but does not engage when 12 VDC is applied to solenoid leads, replace solenoid coil.

5. If valve still does not operate after replacing solenoid coil, replace the valve (see Chapter 4 - Hydraulic System in this manual).

Solenoid coil resistance:

3.5 Ohms ($\pm 10\%$) at 77°F (25°C)

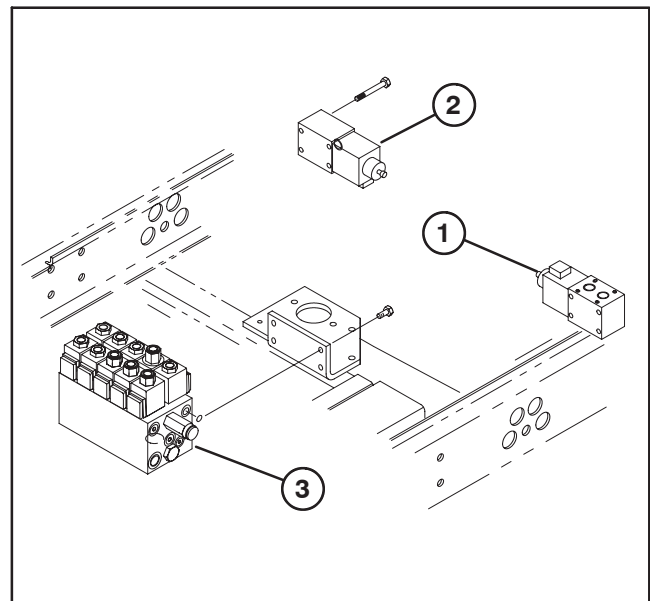

Figure 50
(Located on frame rails)
1. #6 reel solenoid (S10)
2. #7 reel solenoid (S11)
3. Rear valve block